



Antarctica21

INTRODUCING
MAGELLAN DISCOVERER

A21

Magellan Discoverer

Magellan Discoverer is the newest addition to Antarctica21's fleet, joining as a purpose-built vessel specifically designed for our unique Antarctic fly-and-cruise operations.

Launching for the 2026-27 season, Magellan Discoverer represents our continued commitment to exceptional boutique travel experiences in Antarctica.



Artist's Rendering



Artist's Rendering

Like her sister ship, Magellan Explorer, Magellan Discoverer is equipped with advanced polar capabilities that enable safe and comfortable navigation through the Antarctic waters.

As a custom-designed ship, Magellan Discoverer features a sophisticated hybrid-electric propulsion system and sustainable engineering innovations, ensuring efficient operation in one of the world's most pristine environments.

With an elegant yacht-like design and all-balcony accommodations, Magellan Discoverer is the ideal choice for guests seeking adventure, style, and a closer connection with Antarctica.

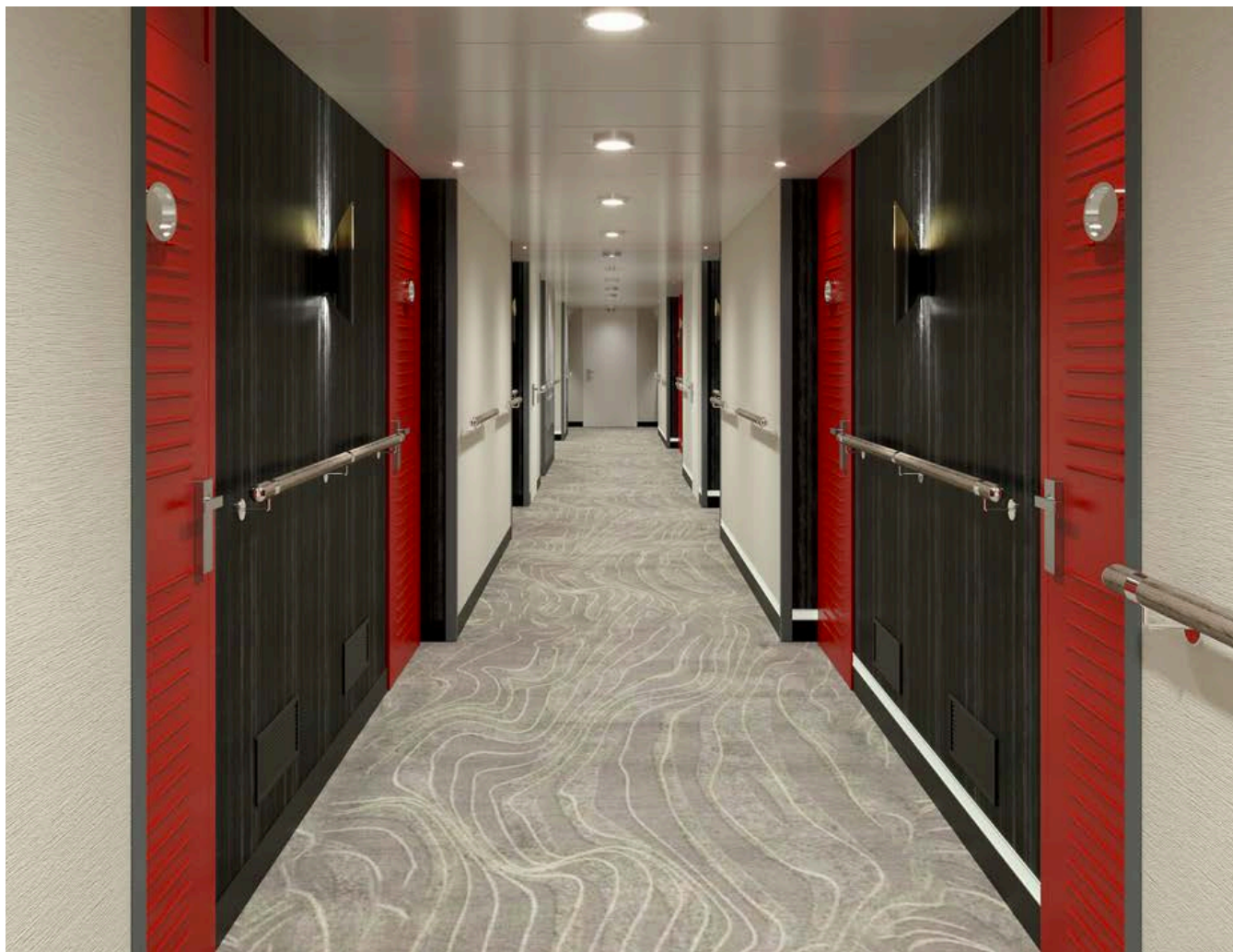

Interior Design

The interiors of Magellan Discoverer, crafted by Tomas Tillberg Design, blend elegance with functionality for polar expeditions. Inspired by Antarctica21's signature style, the design merges high-end comfort with durable finishes suited to harsh conditions. The collaborative process included visits by the design team to Magellan Explorer and Antarctica21's Explorer's House to align with the brand's aesthetic and guest experience.

Modern industrial elements, like black metal accents and warm, neutral tones, provide continuity with Explorer's House. Large windows in public areas enhance views, creating an inviting space that balances luxury with the spirit of exploration. The result is refined yet functional interiors true to Antarctica21's adventurous essence.

Suites and Cabins

With spacious all-balcony cabins and a range of premium suites, Magellan Discoverer redefines comfort in Antarctic travel.

Each cabin is meticulously designed to offer maximum comfort and functionality, featuring a private sitting area, ample wardrobe space, and a sleek, modern bathroom with heated floors. Higher ceilings and expanded layouts make the accommodations feel open and airy, allowing guests to relax in style after a day of exploration.

The ship offers twelve exclusive suites, including two Family Suites and two Triple Suites, ideal for small groups and families. Each suite and cabin is equipped with large windows and sliding glass doors that open onto private balconies, providing guests with uninterrupted views of Antarctica's awe-inspiring landscapes.



Artist's Rendering



Artist's Rendering



Artist's Rendering



Artist's Rendering



Artist's Rendering



Artist's Rendering



Artist's Rendering



Artist's Renderings

Amenities & Services



Magellan Discoverer offers an array of amenities and services tailored to enhance every aspect of the Antarctic experience. Guests can enjoy the observation lounge, which serves as a social hub with a bar and seating areas perfect for taking in the panoramic views or attending engaging presentations by our expert polar guides.

The dining room, accommodating all guests at once, serves a curated menu inspired by regional Chilean flavors paired with premium Chilean wines.

Additional amenities include a sauna with a view of the ice-scapes, a well-stocked library featuring books on Antarctic history and wildlife, a fitness center, a gift shop, and a protected barbecue area for outdoor dining when weather permits.

Each amenity is designed to foster an inviting and friendly atmosphere that enhances the journey to Antarctica.

The Vessel's Features

Built to the latest Polar Code specifications, Magellan Discoverer is a highly capable and eco-conscious vessel designed for smooth, safe Antarctic navigation. The ship holds a Polar Class 6 ice-rating, with a reinforced double hull, and is powered by two 1,800 kW MAN main engines alongside an advanced hybrid-electric system. This hybrid system, supported by Corvus energy storage battery packs, allows the vessel to minimize fuel consumption and emissions. The ship is fitted with two Azipod units from ABB, providing optimal maneuverability and a quieter operation that limits disruption to sensitive Antarctic wildlife.

Magellan Discoverer also boasts state-of-the-art safety and environmental technologies, including a heat recovery system that captures and recycles engine heat to warm the ship and water, contributing to efficient energy use.

For expedition activities, Magellan Discoverer is equipped with two multi-purpose meeting rooms, 10 Zodiacs, and a wet lab for onboard research and science programs. With its top wraparound deck and accessible bow, Magellan Discoverer ensures guests have unforgettable access to the natural wonders of Antarctica, delivering a transformative experience in comfort and style.



The Vessel's Features

GUEST FEATURES

- Observation lounge with a bar, offering panoramic views and serving as the ship's social hub
- All-balcony cabins with private sitting areas and modern furnishings
- A bar offering a selection of Chilean and international drinks
- Spacious sauna with a large window overlooking the Antarctic landscapes
- Well-equipped fitness center
- Library with a collection of Antarctic-themed books and resources
- Expansive wraparound deck for 360-degree views and optimal wildlife observation
- Gift shop stocked with curated expedition essentials and souvenirs
- Multi-purpose meeting rooms for presentations, workshops, and citizen science programs
- Satellite internet service available and accessible wirelessly throughout the ship
- Wet Lab
- Local intranet with daily programs, international news, etc., accessible wirelessly throughout the ship through the Antarctica21 app
- Forward observation deck and accessible bow
- Zodiac embarkation area equipped with hangers, lockers, and sitting facilities.



The Vessel's Features

DINING FEATURES

- Main dining room with single seating for all guests, offering a buffet breakfast and lunch, with table service for dinner
- Selection of premium Chilean wines served with lunch and dinner, emphasizing local flavors
- Protected outdoor barbecue area, perfect for al fresco dining when weather permits
- Round-the-clock self-service coffee, tea, and snacks available in the lounge and library areas
- Special welcome and farewell events with hors d'oeuvres and drinks to celebrate the expedition
- Protected barbecue area for outdoor dining when weather permits.



Specifications

Passengers: 76 on air-cruises / 96 on sea voyages

Expedition Staff & Crew: 67

Lifeboats: 2, fully enclosed, capacity of 124 (in addition to 6 life rafts, capacity of 120)

Length: 94 m

Breadth: 17.2 m

Draft: 4.5 m

Propulsion: Hybrid-Electric Diesel engines, 2 x 1,800 kW

Ice Class: PC6

Cruising Speed: 14 knots in open water

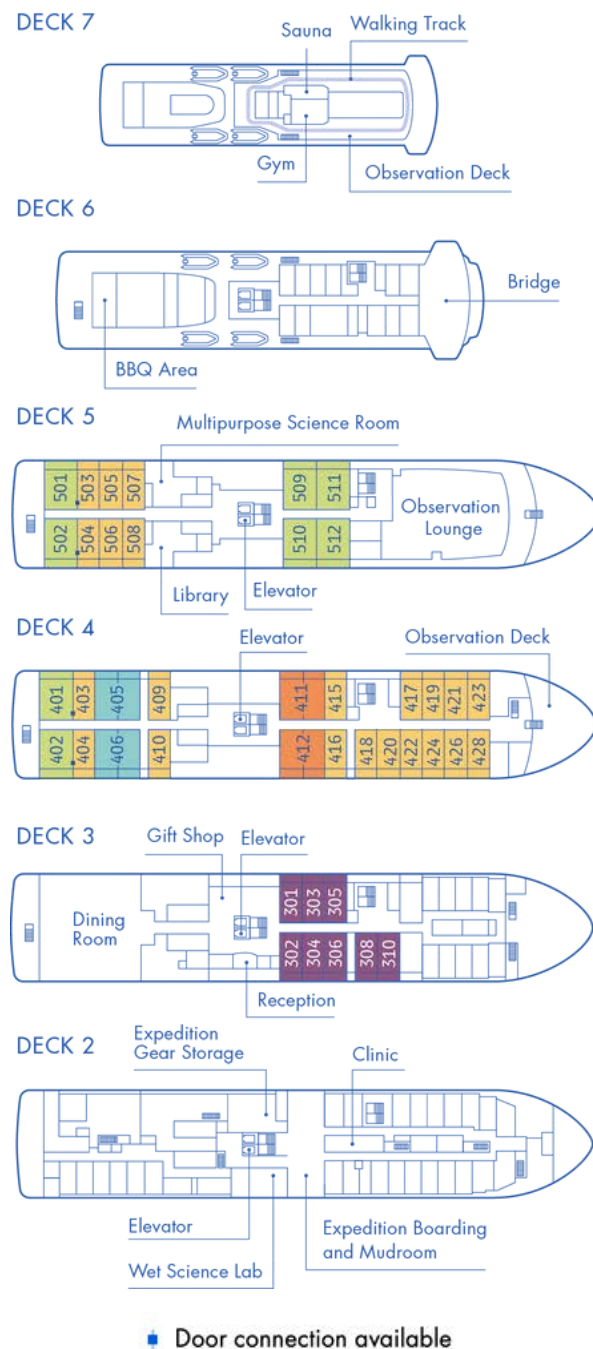

■ Door connection available

Cabins

Category	Approx. Size	Details
Single Veranda Cabin	280 ft ² 26 m ²	Cabin with sitting area and balcony
Grand Veranda Suite	409 ft ² 38 m ²	Suite with sitting area and balcony
Family Veranda Suite	560 ft ² 52 m ²	Two-room suite with sitting area and balcony
Deluxe Veranda Cabin	280 ft ² 26 m ²	Cabin with sitting area and balcony
Triple Veranda Suite	560 ft ² 52 m ²	Two-room suite with sitting area and balcony

SUITES AND CABINS DETAILS

Grand Veranda Suite

- 409 ft² / 38 m²
- Bathroom with shower en suite
- Private Balcony
- Sofa Bed
- Living area
- Desk and chair
- Walk-in closet
- Fridge
- Safe
- Coffee maker
- TV

The bed can be configured as either one king-size bed or two twin beds.

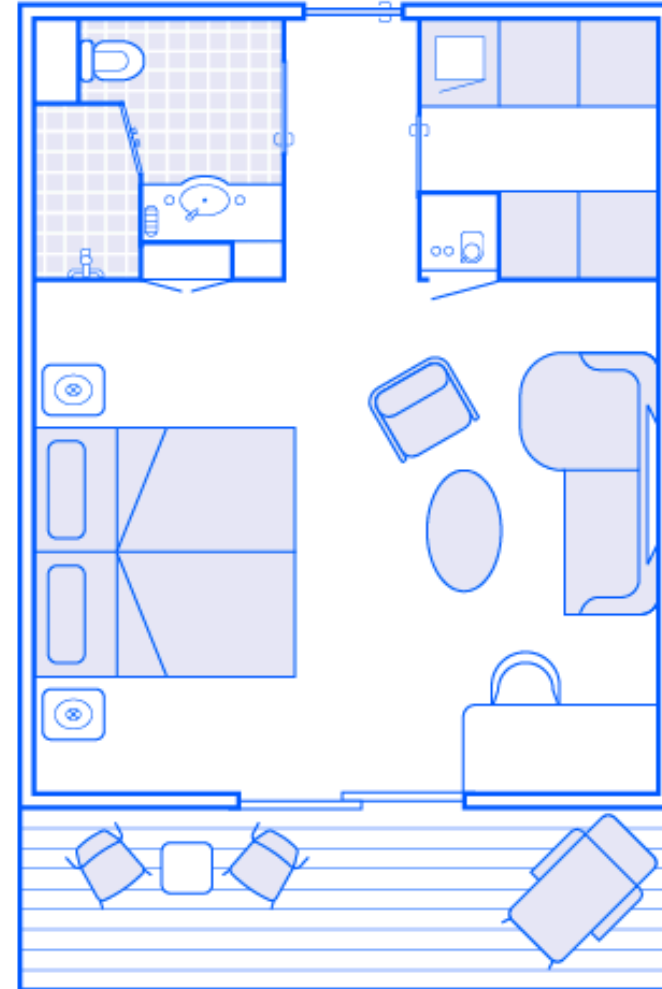

SUITES AND CABINS DETAILS

Deluxe Veranda Cabin

- 280 ft² / 26 m²
- Bathroom with shower en suite
- Private Balcony
- Desk and chair
- Bench and coffee table
- Closets
- Fridge
- Coffee maker
- Safe
- TV

The bed can be configured as either one king-size bed or two twin beds.

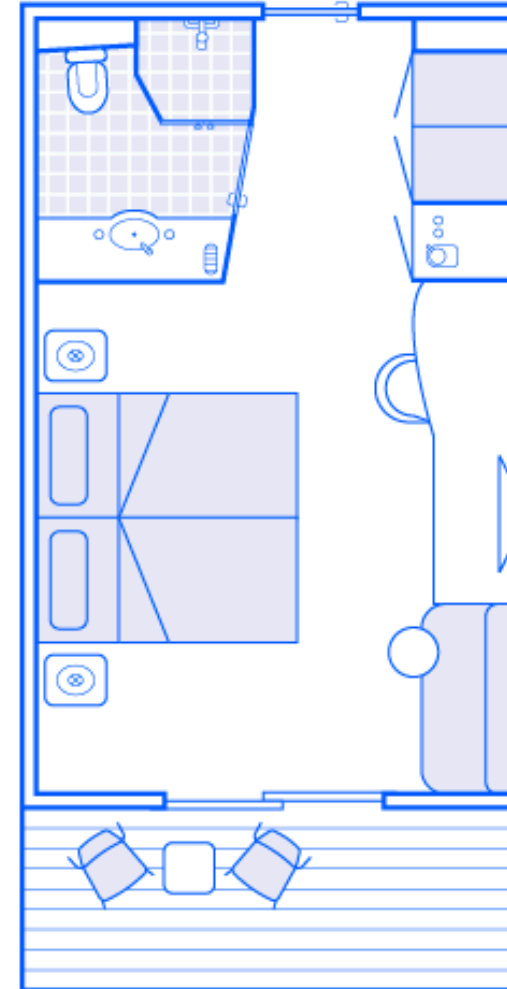

A21

SUITES AND CABINS DETAILS

Single Veranda Cabin

- 280 ft² / 26 m²
- Bathroom with shower en suite
- King bed
- Private Balcony
- Desk and chair
- Bench and coffee table
- Closets
- Fridge
- Coffee maker
- Safe
- TV

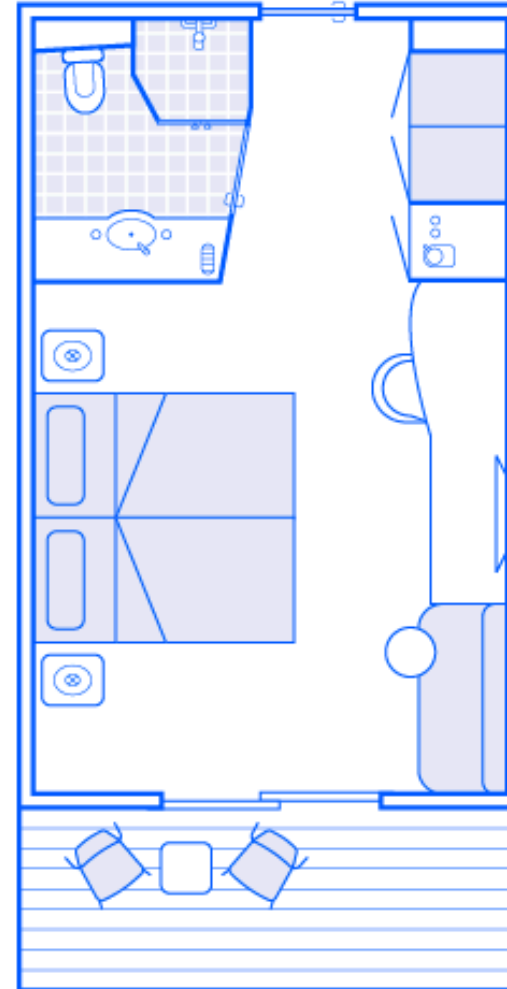

SUITES AND CABINS DETAILS

Family Suite

- 560 ft² / 52 m²
- Connecting door between both cabins
- Two bathrooms with showers en suite
- Accommodates four guests
- Private Balconies
- Desks and chairs
- Benches and coffee tables
- Closets
- Fridges
- Safes
- Coffee makers
- TVs

Beds can be configured as either one king-size bed or two twin beds.

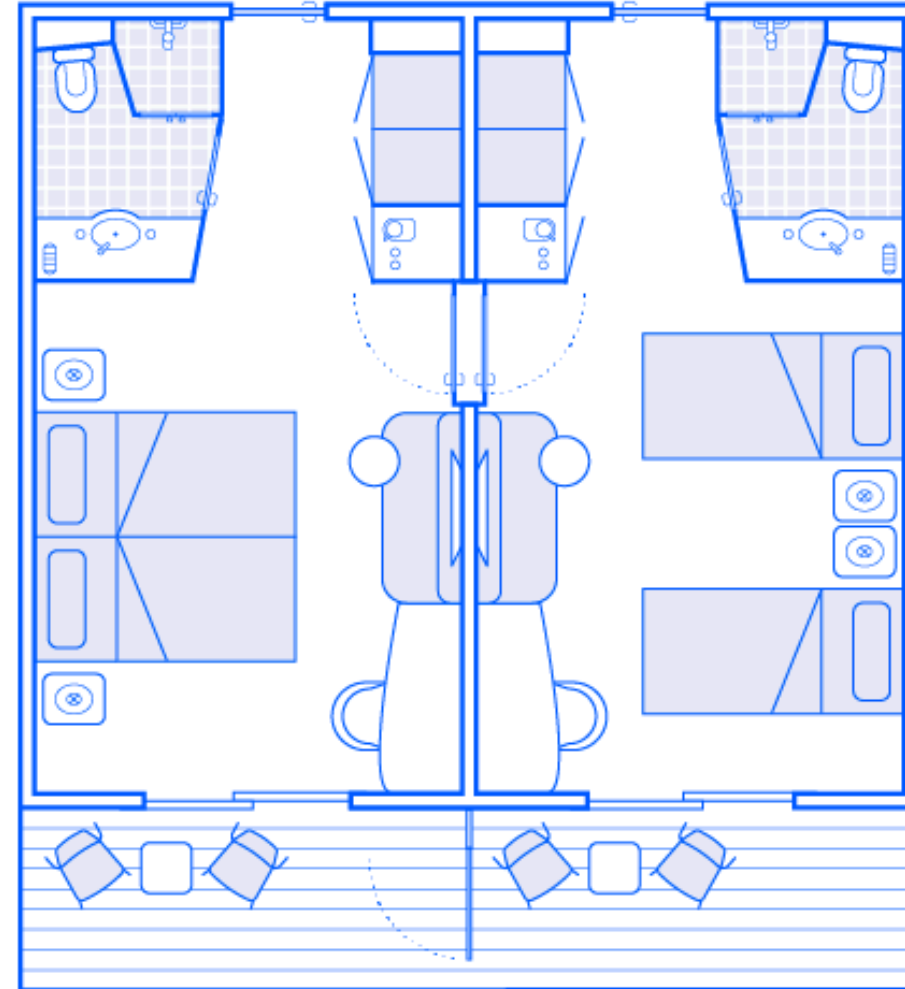

A21

SUITES AND CABINS DETAILS

Triple Veranda Cabin

- 560 ft² / 52 m²
- Connecting door between both cabins
- Two bathrooms with showers en suite
- Accommodates three guests
- Private Balconies
- Desks and chairs
- Benches and coffee tables
- Closets
- Fridges
- Safes
- Coffee makers
- TVs

Beds can be configured as either one king-size bed or two twin beds

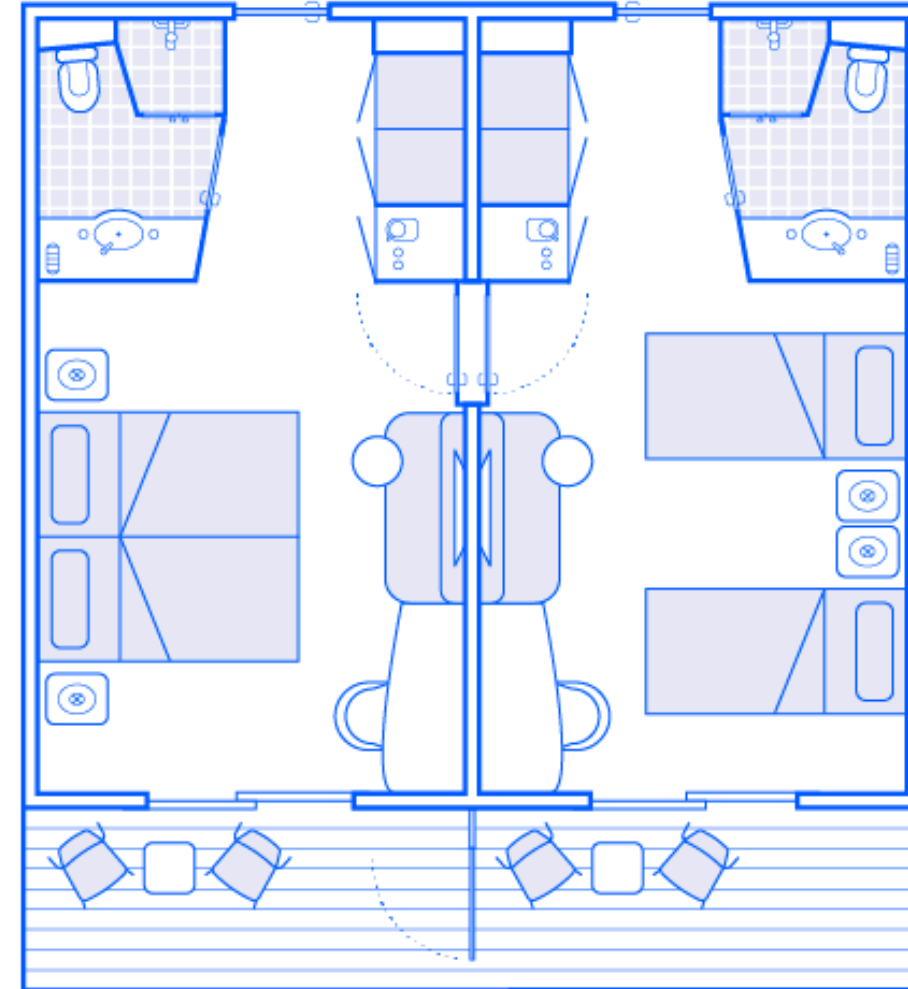

SUITES AND CABINS DETAILS

Premium Family Option

Combine a Grand Veranda Suite with a connecting Deluxe Veranda Cabin

- Grand Veranda Suite: 409 ft² / 38 m²
- Deluxe Veranda Cabin: 280 ft² / 26 m²
- Connecting door between the Grand Veranda Suite and the Deluxe Veranda Cabin
- Two bathrooms with showers en suite
- Private Balconies
- Desks and chairs
- Benches and coffee tables
- Sofa
- Living area
- Walk-in closet
- Closets
- Two fridges
- Coffee makers
- Safes
- TVs

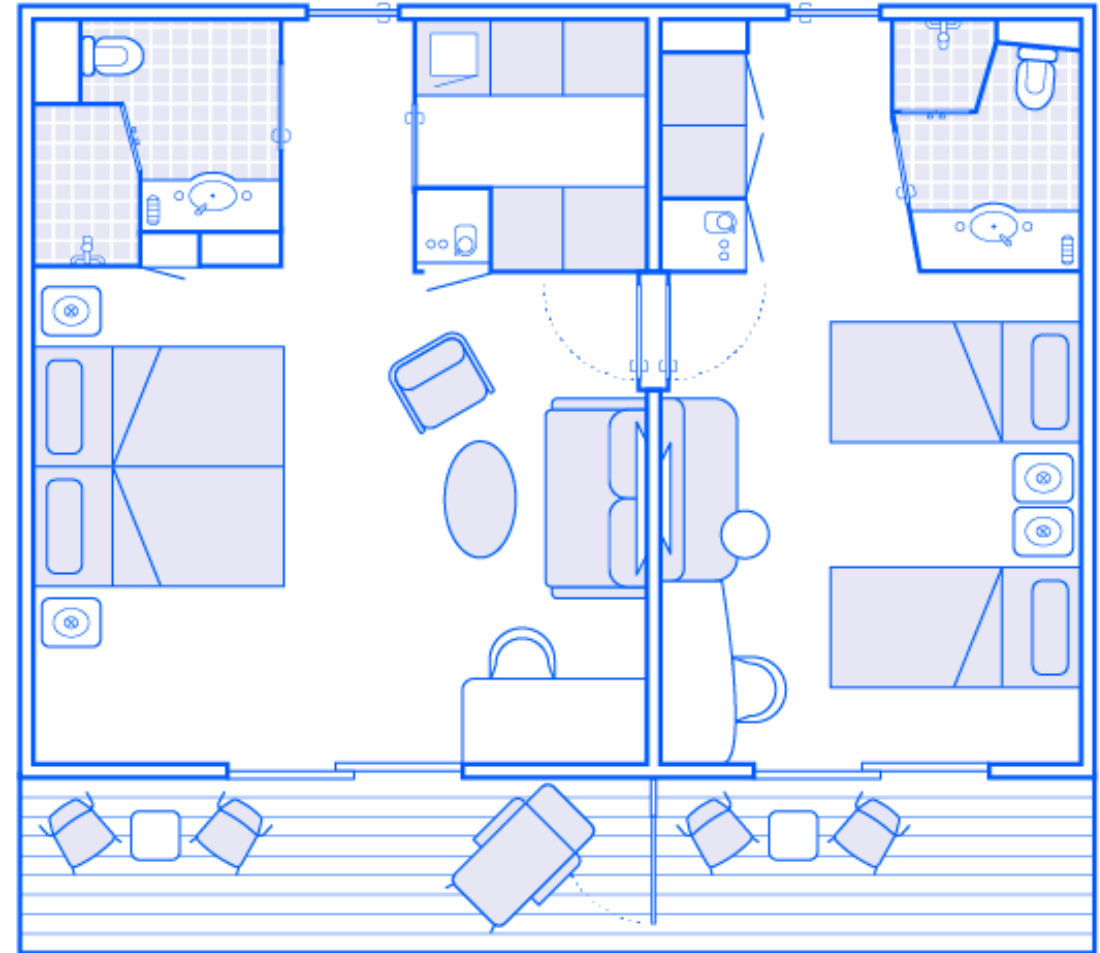

Beds in both the suite and cabin can be configured as either one king-size bed or two twin beds.

The Vessel's Features

TECHNICAL FEATURES

- Polar Class 6 ice-rating, meeting the latest Polar Code specifications for safe Antarctic navigation
- Two 1,800 kW MAN main engines
- Selective Catalytic Reduction (SCR) system for Tier III compliance, minimizing nitrogen oxide emissions
- Heat recovery system that captures and recycles engine heat to warm the vessel and water supply
- Two fully enclosed lifeboats, capacity of 124 (in addition to 6 life rafts, capacity of 120)
- Fleet of 10 Zodiacs, equipped for safe, efficient guest disembarkation and exploration



The Vessel's Features

TECHNICAL FEATURES - PROPULSION SYSTEM

The hybrid-electric propulsion system includes three key components:

- A proven, safe, and resilient Onboard DC Grid. It provides an independent source of energy.
- Two ABB Azipods, featuring 360° rotation for maximum maneuverability. Azipods reduce underwater radiated noise and vibrations for the ultimate comfort for guest. This sustainable propulsion technology that has saved over 1 million tons of fuel on cruise ships over 25 years. 95% of the material used is recyclable.
- A Corvus battery-based energy storage system for backup power and reduced emissions. It allows for the use of smaller main diesel engines and enables silent, zero emission operations.



Collaboration with World Leaders

For the construction of Magellan Discoverer, Antarctica21 collaborated with world leaders in passenger ship design and technology to create a state-of-the-art expedition vessel.

The project was entrusted to the renowned ASENNAV shipyard in Chile, known for its excellence in shipbuilding.

The ship is powered by reliable MAN engines and features ABB Azipods for enhanced maneuverability and fuel efficiency.

A cutting-edge hybrid-electric system by Corvus Energy was integrated to reduce emissions and support sustainable operations. Fincantieri will supply a retractable fin stabilizer plant. With a hybrid lubrication system and minimal water drag, the plant limits fuel consumption and adds another vital green feature on the vessel.

The vessel's elegant and functional interiors were designed by Tomas Tillberg Design, bringing decades of expertise to ensure a sophisticated yet practical environment for polar exploration.

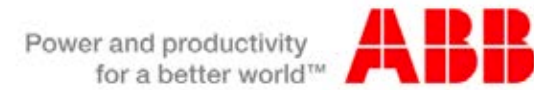



Interior Design

Interview with Nedgé Louis-Jacques, Managing Partner at Tomas Tillberg Design

Tells us about the Tomas Tillberg Design team.

For over 60 years and across two generations, the Tillberg name has been recognized as a global leader in cruise ship and ferry design. Our experienced professionals and diversified partner networks have years of experience exceeding our customers' expectations and serving clients globally.

We strive to service all aspects of a project, from concept, product development, design, specifications, negotiations, and all phases of implementation, including development and quality control, among many others. Additionally, our team takes pride in pioneering the cruise ship industry. We have participated in many projects that have broken the norm and been the first of its kind.

How do you approach new design projects?

At Tomas Tillberg Design, our goal is to approach each project by deeply understanding the client's brand, including vision, product development, operation, style, marketing strategies, and customer profile, among many other specifics. With Antarctica21, David Tovar, Project Director at Tomas Tillberg Design, and I visited Chile, with stops in Valdivia, for an onboard visit of Magellan Explorer and Punta Arenas, Antarctica21's home base. We toured Explorers House, the beautiful expedition center, and had several meetings with key members of the Antarctica21 team to understand the brand, its aesthetic, its values, and their application.

We have extensive experience developing complete designs for expedition ships. Using that experience, we are working on incorporating design elements that align with the Antarctica21 brand while enhancing the guest experience.



Nedgé Louis-Jacques
Managing Partner
Senior V.P. of Design

What are the key design concepts behind Magellan Discoverer?

In general terms, we are delivering that wonderful balance of casual elegance and expedition feel that so clearly defines the Antarctica21 brand. We are carrying some of the modern industrial details and elements from Explorers House through to Magellan Discoverer. These can be identified in many ways: the black and graphite metal accent used in many decorative lighting fixtures; the neutral and warm color palette to display a blend of high-end comfort with practical, durable finishes; and the shape of the reception desk, to name a few.

How does the design of Magellan Discoverer relate to its sister ship, Magellan Explorer, and Explorers House?

From our brief, we understood clearly that it was essential to develop a cohesive design language that connected the three entities. It is important to our team and to Antarctica21 that we provide a sense of familiarity with the sister ship and with the expedition center. At the same time, we are working to position Magellan Discoverer's overall ship design as the leading ship in the fleet. It is an even more premium product compared to Magellan Explorer.

How is Magellan Discoverer different from other projects you have worked on?

Though we've designed many expedition ships, Magellan Discoverer is undoubtedly unique for many reasons. The Antarctica21 brand identity and onboard experience have a unique brand story and philosophy. These values impact everything from interior aesthetics to onboard programming and amenities.

Also, we saw immediately that Explorers House as a pre- and post-expedition hub brings a different aspect to this project. It really sets the tone and definitely provides great inspiration.

And working with the Antarctica21 team has been quite a treat. We are truly enjoying every aspect of the work and the unique personality and purpose of this project. We're happy to be a part of the team.

Innovating the Antarctic Experience

Interview with Jaime Vásquez, President of Antarctica21

Why did Antarctica21 decide to build Magellan Discoverer?

The decision to build Magellan Discoverer followed the tremendous success of our first custom-built ship, Magellan Explorer, which allowed us to deliver a uniquely personalized Antarctic experience. We saw clear market demand for our specialized air-cruise model—a style that eliminates the long, rough Drake Passage crossing and brings guests directly into the heart of Antarctica. Magellan Discoverer completes our fleet of small ships, entirely under our control, allowing us to offer even more immersive boutique expeditions. This level of ownership allows us to ensure that the entire guest experience aligns with Antarctica21's values, where every detail contributes to an immersive, comfortable, and memorable journey.

What is your role in the construction of the ship? Who are the key players in the project?

I'm deeply involved in guiding the project's vision and working closely with our partners. We are again partnering with the renowned Chilean shipyard ASENNAV, where we built Magellan Explorer. ASENNAV brings vast experience, and our collaboration has only strengthened over the years. Leading the engineering aspects is Claudio Bobadilla from Antarctica21, who coordinates with key suppliers like MAN for the engines, ABB for the Hybrid Diesel-Electric System and Azipods, Corvus for the energy storage system, Fincantieri for the stabilizers, and the design expertise of Tomas Tillberg. Together, this team brings the precision and innovation needed to meet our rigorous standards for a new-generation expedition ship.



Jaime Vásquez
Mechanical Engineering



Claudio Bobadilla
Electrical Engineering

What key technical requirements were considered for the ship?

In designing Magellan Discoverer, our priority was to create a vessel purpose-built for Antarctic exploration, one that aligns with stringent environmental and safety standards. To meet these requirements, we integrated Polar Class 6 ice-rating standards, ensuring the ship could navigate through ice-laden waters with resilience and stability.

Additionally, we installed dual Azipods, an advanced propulsion system that provides unmatched maneuverability in tight areas and during delicate operations near wildlife, allowing the ship to respond precisely to changing conditions. We also focused on reducing emissions and minimizing environmental impact by equipping the ship with a Selective Catalytic Reduction (SCR) system for Tier III compliance, which significantly cuts nitrogen oxide emissions, meeting the latest environmental benchmarks for the region. By incorporating these technical advancements, we've prepared Magellan Discoverer for the demands of sustainable polar operations.

What are the similarities and differences between Magellan Discoverer and its sister ship, Magellan Explorer?

Both Magellan Discoverer and Magellan Explorer are purpose-built expedition vessels, designed from the keel up for our Antarctic fly-and-cruise operations. They share the same boutique size and elegant yacht-like appearance, offering an intimate guest capacity, which allows for efficient disembarkation and maximizes time ashore. Both ships are equipped with Zodiac embarkation areas, an accessible bow for close wildlife viewing, and observation lounges that connect guests with the natural surroundings.

However, with Magellan Discoverer we took the opportunity to introduce enhancements based on feedback and evolving guest preferences. Magellan Discoverer features premium all-balcony accommodations, with larger surface areas and additional seating, and higher ceilings, which create a more open, airy feel within each cabin and suite. The ship also includes a top wraparound deck for 360-degree views, offering an immersive experience of Antarctica's landscapes. Technically, Magellan Discoverer includes a state-of-the-art hybrid-electric propulsion system, increasing fuel efficiency and reducing our carbon footprint—a significant step forward in sustainable operation.

Tell us about the sustainability features of the vessel.

Sustainability is a core value for us at Antarctica21, and Magellan Discoverer has been built with advanced systems to reflect that commitment. The hybrid-electric propulsion system, supported by Corvus Energy battery storage packs, allows the ship to rely on electric power during certain operations, significantly lowering fuel consumption and emissions. This system is complemented by Azipods, which are 15% more fuel-efficient on average and enable the ship to operate quietly, minimizing disturbance to wildlife and fragile ecosystems.

Additionally, we implemented a heat recovery system that captures and reuses waste heat from the engines to warm the vessel and water supply, reducing our reliance on additional fuel. Even the kinetic energy generated by the elevator's downward movement is turned into electricity that is stored in batteries.

Our latest initiative is a partnership with HIF Global, a world leader in e-fuel production, whereby we have become the first company in the cruise industry to integrate synthetic gasoline into its operations. Through this partnership, we plan to expand the use of e-Fuels to include synthetic Marine Gas Oil (e-MGO) to power our ships' main engines, as well as synthetic jet fuel for our air operations.

Our commitment goes beyond technology. Antarctica21 is devoted to leading responsible travel in Antarctica, setting high standards in environmental protection, safety, and education. Since 2019 we have been a CarbonNeutral® certified company, purchasing carbon credits in wind energy projects in Chile and Guatemala to offset emissions and support renewable energy production. Our vision for 2030 is to serve as a global model for sustainable travel in Antarctica and the sub-Antarctic regions, providing meaningful, transformative experiences that encourage guests to value and protect this last, wild frontier. Through continuous innovation, collaboration with the scientific community, and respect for local ecosystems and wildlife, we are dedicated to ensuring that Antarctica remains preserved for future generations.

Contact us

Your questions are welcome

For further information and inquiries, you can contact our Reservation and Customer Service Team.

Tel: +56 (2) 2231 8142

Toll-free USA and Canada: +1 (877) 994-2994

Email: sales@antarctica21.com

Our office hours:

Monday to Friday

From 8:30 am to 6:00 pm · Santiago, Chile time

Visit www.antarctica21.com

Antarctica21

Fly & Sail Expeditions

Visit us at antarctica21.com

Last updated on November 8, 2024